

Fittings
Fittings



Mit viega Fittings aus Rotguss und Kupfer lassen sich hochwertige und langlebige Rohrleitungen zur Werkzeugkühlung erstellen. Neben den hier aufgeführten Produkten bieten wir Ihnen gerne auch weitere Produkte aus dem viega Gesamtsortiment an.

With viega fittings made of red brass and copper, high-quality and durable pipelines for tool cooling can be created. In addition to the products listed here, we can also offer you other products from viega's complete product range.

Bogen I-A 45° / Elbow I-A 45°

Kupfer / Lötanschluss / Einsteckanschluss
copper / soldering connection / plug-in connection

d	Z	L1	L2	Artikel-Nr. / Item No.
12	5	15	16	21004010
15	6	17	19	21004110
18	8	21	22	21004210
22	9	25	27	21004310

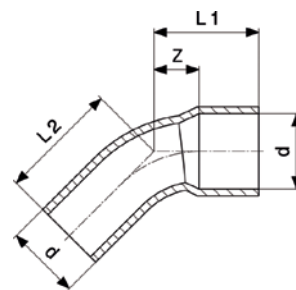

Bogen I-I 45° / Elbow I-I 45°

Kupfer / Lötanschluss
copper / soldering connection

d	Z	L	Artikel-Nr. / Item No.
12	5	14	21004000
15	6	17	21004100
18	8	21	21004200
22	9	25	21004300

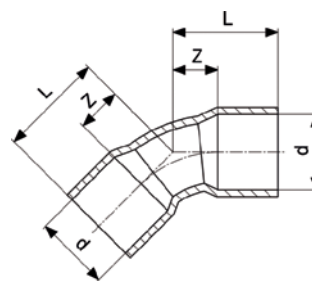

Winkel I-A 90° / Elbow I-A 90°

Kupfer / Lötanschluss / Einsteckanschluss
copper / soldering connection / plug-in connection

d	Z	L1	L2	Artikel-Nr. / Item No.
12	12	21	25	21000210
15	12	23	25	21000410
18	14	27	30	21000510
22	15	31	37	21000610

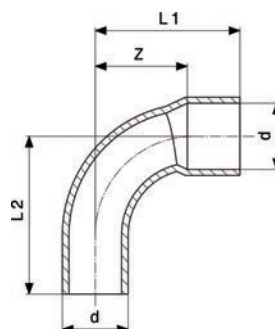

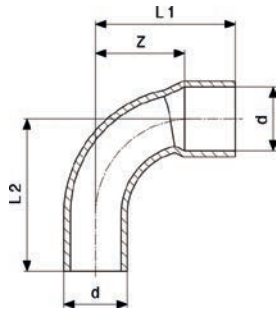

Bogen I-A 90° / Elbow I-A 90°

Kupfer / Lötanschluss / Einsteckanschluss
copper / soldering connection / plug-in connection

d	Z	L1	L2	Artikel-Nr. / Item No.
12	14	23	25	21000260
15	18	29	31	21000460
18	22	35	37	21000560
22	26	42	43	21000660

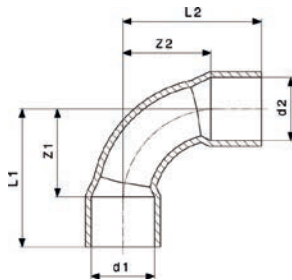

Winkel I-I 90° / Elbow I-I 90°

Kupfer / Lötanschluss
copper / soldering connection

d1	d2	Z1	Z2	L1	L2	Artikel-Nr. / Item No.
10	10	14	14	22	22	21000100
12	12	12	12	21	21	21000200
15	15	10	10	21	21	21000400
18	18	12	12	25	25	21000500
22	22	15	15	31	31	21000600

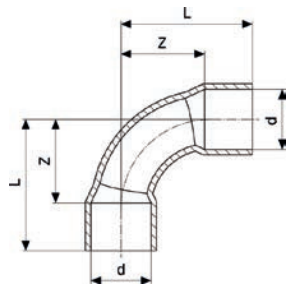

Bogen I-I 90° / Elbow I-I 90°

Kupfer / Lötanschluss
copper / soldering connection

d	Z	L	Artikel-Nr. / Item No.
12	14	23	21000250
15	18	29	21000450
18	21	34	21000550
22	26	42	21000650

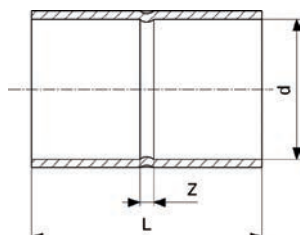

Muffe / Fitting

Kupfer / Lötanschluss
copper / soldering connection

d	Z	L	Artikel-Nr. / Item No.
12	2	19	21003600
15	2	23	21003610
18	2	27	21003620
22	2	32	21003630

RG-Muffe / Red brass fitting

Rotguss / Rp-Gewinde
red brass / Rp-thread

Rp	L	SW	Artikel-Nr. / Item No.
3/8	23	21	21005110
3/4	33	32	21005100
1	38	38	21005120

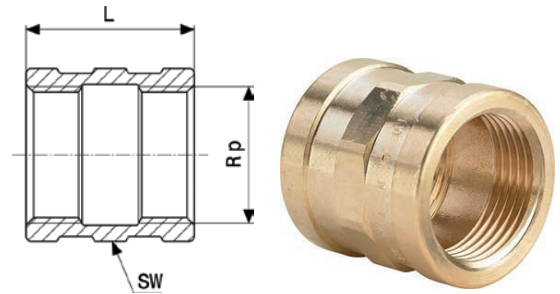

Reduziermuffe / Reducing bushing

Rotguss / Rp-Gewinde
red brass / Rp-thread

Rp1	Rp2	Z	L	SW	Artikel-Nr. / Item No.
3/4	3/8	6	34	31	21003900
3/4	1/2	0	32	31	21003905
1	3/4	0	36	38	21003910

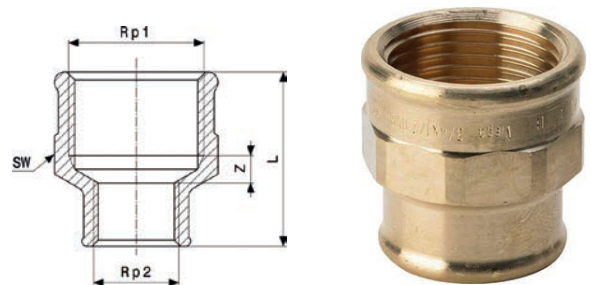

Reduzierstück / Reducer

Kupfer / Lötanschluss / Einsteckanschluss
copper / soldering connection / plug-in connection

d1	d2	Z	L	Artikel-Nr. / Item No.
12a	10	1	19	21002100
15a	10	6	27	21002400
15a	12	3	24	21002500
18a	12	4	27	21002800
18a	15	4	29	21003000
22a	12	7	33	21003200
22a	15	6	37	21003400
22a	18	5	35	21003500

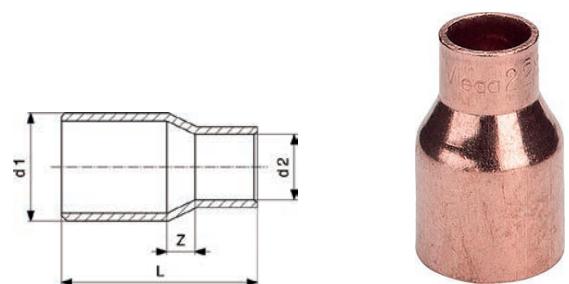

Langnippel / Long nipple

Rotguss / Innenvielkant
red brass / polygonal socket

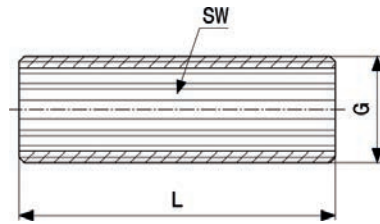
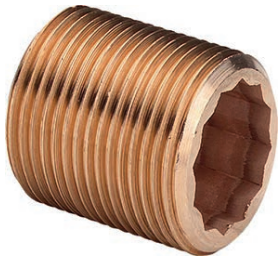

G	L	SW	Artikel-Nr. / Item No.
3/4	40	17	21003800
3/4	60	17	21003810
3/4	80	17	21003820
3/4	100	17	21003830
1	40	22	21003840
1	60	22	21003850
1	80	22	21003860
1	100	22	21003880

T-Stück / T-piece

Kupfer / Lötanschluss
copper / soldering connection

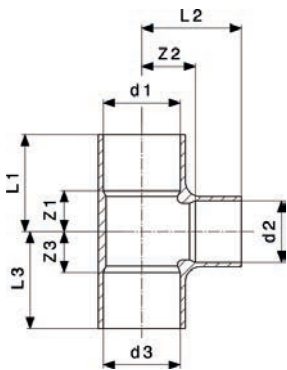
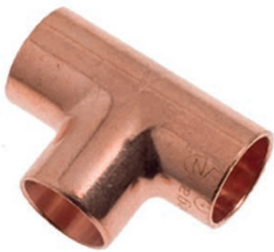

d1	d2	d3	Z1	Z2	Z3	L1	L2	L3	Artikel-Nr. / Item No.
12	12	12	7	7	7	16	16	16	21001200
15	15	15	8	9	8	19	20	19	21001400
18	18	18	10	11	10	23	24	23	21001500
22	22	22	12	12	12	28	28	28	21001600
15	12	15	8	11	8	19	20	19	21001410
18	12	18	8	13	8	21	22	21	21001511
18	15	18	8	13	8	21	24	21	21001510
22	15	22	9	12	9	25	23	25	21001610
22	18	22	11	14	11	27	27	27	21001620

Kappe / Cap

Kupfer / Lötanschluss
copper / soldering connection

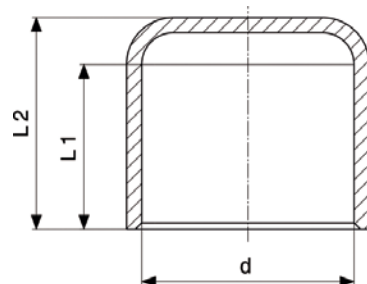

d	L1	L2	Artikel-Nr. / Item No.
12	9	11	21004500
15	11	13	21004510
18	13	15	21004520
22	15	18	21004530

RG-Kreuzstück / Cross fitting

Rotguss / Lötanschluss
red brass / soldering connection

d	Z	L	Artikel-Nr. / Item No.
15	20	42	21004600
18	24	50	21004610
22	27	58	21004620

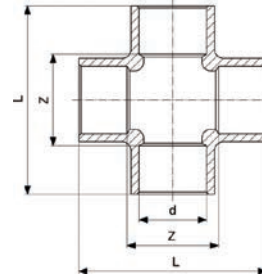

RG-T-Stück / T-piece

Rotguss / Lötanschluss / Rp-Gewinde
red brass / soldering connection / Rp-thread

d1	Rp	d2	Z1	Z2	Z3	L1	L2	L3	Artikel-Nr. / Item No.
15	3/8	15	10	6	10	21	18	21	22000300
15	1/2	15	12	8	12	23	23	23	22000410
18	3/4	18	17	9	17	30	25	30	22000600
22	3/4	22	17	10	17	32	27	32	22000800

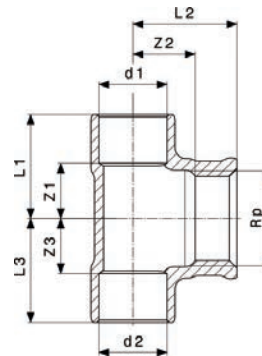

RG-Übergangsstück / Adapter piece

Rotguss / Lötanschluss / R-Gewinde
red brass / soldering connection / Rp-thread

d	R	Z	L	SW	Artikel-Nr. / Item No.
12	3/8	12	21	16	21003700
15	3/8	13	24	19	21003710
15	3/4	16	27	19	21003720
18	3/4	13	26	21	21003730
22	3/4	16	32	26	21003740

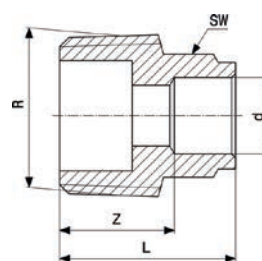

Stopfen / Plug

Rotguss / R-Gewinde / Vierkant / Außenrand
red brass / R-thread / square headed / outer edge

R	L	SW	Artikel-Nr. / Item No.
3/8	20	10	21005000
3/4	28	14	21005010
1	32	14	21005020

